

Applications: provide high quality filtration solutions for water with high contamination of organic material and algae.

Standard Characteristics:

- **Filter housing material of construction:** Carbon Steel ST37.2
- **Pre-treatment:** sand blasting up to Sa 2.5 grade
- **Exterior & Interior coating:** electrostatic oven baked polyester-epoxy powder coating with a thickness of 150-200 micron
- **Connections:** Victaulic, Threaded socket and Flange
- **Maximum recommended working pressure:** 8 bars (116 psi).
- Equipped with “mushroom” diffusers with vertical openings
- Diffusion protection for screws, nuts & washers



Operation:

Water enters the filter via the inlet and spreads evenly onto the media.

Solids and organic materials are trapped within the media. The clean water passes through the media and flows out via the nozzles. The back flushing process starts when the DP reaches the **MAXIMUM** preset value of 0.5bar (7 psi) (a higher DP than 0.5 bar may damage the filter). The inlet of the filter closes, allowing the water to enter from the bottom, lifting the media and releasing the solids that exit the filter through the back flush manifold. This process can be controlled automatically.

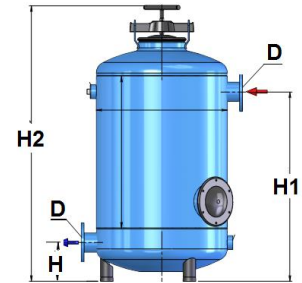

Model F605-F635

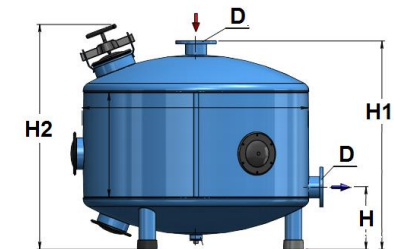

Model F640-F680

Model	In/Out ØD (in)	ØD1 (mm) (in)	Recom. Flow rate (m ³ /h) (gpm)	Min. Backwash Flow rate (m ³ /h) (gpm)	Filtration area (m ²) (ft ²)	H (mm) (in)	H1 (mm) (in)	H2 (mm) (in)	Weight of unit (kg) (lb)	No. of gravel bags of 25 kg (55 lb)
F605	1	323 12	3.5-5 15-22	6 26	0.07 0.75	150 5.91	785 30.91	1160 45.65	45 99	2
F610	1.5	30 16	5.3-9 23-39	10 44	0.12 1.29	180 7.09	870 34.25	1175 46.23	48 106	3
F620	2	480 20	8-13.5 35-59	17 75	0.20 2.15	180 7.09	880 34.65	1280 50.4	60 132	5
F630	3	480 20	8-13.5 35-59	17 75	0.20 2.15	180 7.09	880 34.65	1280 50.4	60 132	5
F635	2	610 24	13.5-20 59-88	25 110	0.29 3.12	180 7.09	880 34.65	1285 50.6	85 187	7
F636	3	610 24	13.5-20 59-88	25 110	0.29 3.12	180 7.09	880 34.65	1285 50.6	85 187	7
F640	3	762 30	20-30 88-132	38 167	0.44 4.73	300 11.81	1070 42.13	1197 47.12	130 287	12
F650	3	900 36	32-44 140-193	55 242	0.64 6.89	300 11.81	1110 43.7	1242 48.9	170 375	16
F660	4	1200 48	55-79 242-348	96 423	1.13 12.16	330 11.81	1110 43.7	1189 46.81	246 542	23
F680	4	1520 60	80-150 352-660	155 683	1.17 19.01	440 17.32	1420 55.9	1515 59.6	515 1135	40

Components Description & Spare Parts ordering information

Part Breakdown		Model									
Filter		F605	F610	F620	F630	F635	F636	F640	F650	F660	F680
Body Filter		12"*1"	16"*1.5"	20"*2"	20"*3"	24"*2"	24"*3"	30"*3"	36"*3"	48"*4"	60"*4"
1	Filter body	N/A	N/A	N/A	N/A	N/A	N/A	N/A	N/A	N/A	N/A
2	Handle	E6020106000	E6020106000	E6020106000	E6020106000	E6020106000	E6020106000	E6020106000	E6020106000	E6020106000	E6020106000
3	Tightening bracket	6012006000-P	6012108000-P	6012108000-P	6012108000-P	6012108000-P	6012108000-P	6012108000-P	6012108000-P	6012108000-P	6012108000-P
4	Cover	5320200601-P	5320010800-P	5320010800-P	5320010800-P	5320010800-P	5320010800-P	5320010800-P	5320010800-P	5320010800-P	5320010800-P
5	Cover gasket	5311150600-040	5311200600-120	5311200600-120	5311200600-120	5311200600-120	5311200600-120	5311200600-120	5311200600-120	5311200600-120	5311200600-120
6	"Mushroom" diffuser	4000016500	4000016500	4000016500	4000016500	4000016500	4000016500	4000016500	4000016500	4000016500	4000016500
7	Rubber bushing	5312000600-280	5312000600-280	5312000600-280	5312000600-280	5312000600-280	5312000600-280	5312000600-280	5312000600-280	5312000600-280	5312000600-280
8	Male plug	4180100300	4180150300	4180200300	4180200300	4180200300	4180200300	4180200300	4180200300	4180200300	4180200300
9	Rubber leg	5312007600-069	5312007600-069	5312007600-068	5312007600-068	5312007600-069	5312007600-069	E5312030600-067	E5312030600-067	E5312030600-067	-----
10	PVC nipple	4240106000-120	4240156000-150	4240206000-200	-	4240206000-250	-	-----	-----	-----	-----
11	Elbow	4170106501	4170156501	4170206501	6226002000	4170206501	6226003000	-----	-----	-----	-----
12	Service cover 6"	-----	5320010600-P	5320010600-P	5320010600-P	5320010600-P	5320010600-P	5320010600-P	5320010600-P	5320010600-P	-----
13	Service cover 6" gasket	-----	5311150600-045	5311150600-045	5311150600-045	5311150600-045	5311150600-045	5311150600-045	5311150600-045	5311150600-045	-----
14	Bolt	-----	4102110401-030	4102110401-030	4102110401-030	4102110401-030	4102110401-030	4102110401-030	4102110401-030	4102110401-030	-----
15	Washer	-----	4122110401	4122110401	4122110401	4122110401	4122110401	4122110401	4122110401	4122110401	-----
16	Nut	-----	4112110401	4112110401	4112110401	4112110401	4112110401	4112110401	4112110401	4112110401	-----
17	Quick connector cover	5320010402-P	-----	-----	-----	-----	-----	-----	-----	-----	5320010402-P
18	Quick connector	4150104000-03P	-----	-----	-----	-----	-----	-----	-----	-----	4150104000-03P
19	Quick connector gasket	4084040200	-----	-----	-----	-----	-----	-----	-----	-----	4084040200

Warnings! Important safety instructions: * Maximum pressure is 8 bar. * Do not open the filter cover without first performing the following actions:

1) Close both the inlet and outlet valves. 2) Open the filter drain and be certain that the filter is fully drained and the pressure is 0. 3)The filter cover can now be carefully opened.

Pressure loss at 120 micron

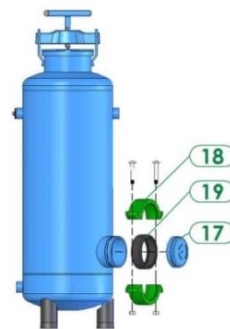
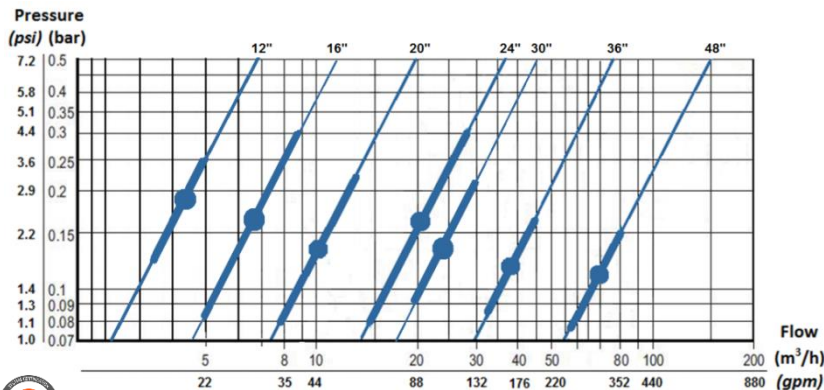

Model: F605

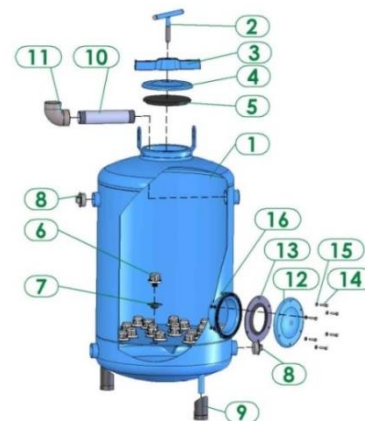

Model: F610-F635

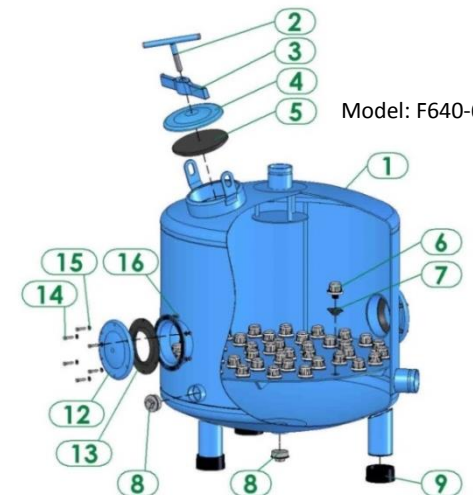

Model: F640-680

